

MFT 锁牙式刀杆系列

MFT Lock teeth cutter bar series

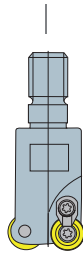

圆鼻立铣刀
Round nose end mill



D28-D36

钻铣刀
Drilling & Milling Cutter

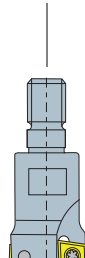

D43-D44

直角台肩铣刀
Right angle shoulder end mill

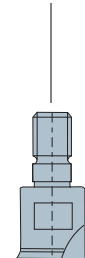

D09-D26

直角台肩精铣刀
Right angle shoulder finish milling cutter

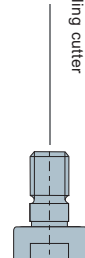

D39-D42

球形精铣刀
Ball milling cutter



D39-D42

双面快进给铣刀
Double face fast forward feed milling cutter



D71-D72

快进给铣刀
Fast forward feed milling cutter



D64-D69

快进给铣刀
Fast forward feed milling cutter

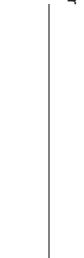

D66

优点 Advantage

高性能可换刀头和刚性刀柄的组合，在悬长较长的加工中亦可有效抑制振动，与传统钢制刀杆相比加工效率提高了2~5倍。加工时间大大缩短，加工成本随之下降。

刀头的自由组合及其可换性，覆盖从粗加工到精加工的所有加工要求，对刀具的集约化管理具有划时代的意义。由于刀柄和刀杆采用螺纹连接，可在机床上方便迅速的更换刀头，降低生产成本。

High-performance interchangeable cutter head and the handle a combination of rigidity, in the long hanging longer processing can effectively suppress vibration, as compared with traditional steel arbor processing efficiency is improved by 2 ~ 5 times. Significantly reduce processing time, processing costs drop.

Segment of the free combination and can be changed, coverage from roughing to finishing all the processing requirements, intensive management tool epoch-making significance. As the shank and arbor with threaded connections, you can easily and quickly on a replacement machine Cutter, reduce production costs.

BT-MFT 锁牙式刀柄

BT/MFT Screwed end mills holder

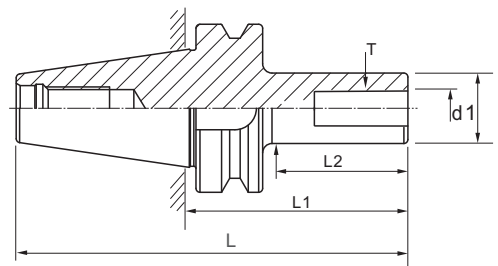

型号 Cat. No	尺寸 Size					重量 Weight (KG)	Stock	Order Number	Price (RMB)
	L	L1	L2	d1	T				
BT40-MFT16-M8-60	160.4	95	60	15	M8	1.1	●	336100	350
BT40-MFT16-M8-110	210.4	145	110	15	M8	1.2	●	336102	350
BT40-MFT20-M10-60	160.4	95	60	19	M10	1.1	●	336104	350
BT40-MFT20-M10-110	210.4	145	110	19	M10	1.2	●	336106	350
BT40-MFT25-M12-60	160.4	95	60	24	M12	1.1	●	336108	350
BT40-MFT25-M12-120	220.4	155	120	24	M12	1.3	●	336110	350
BT40-MFT30-M16-50	150.4	85	50	28	M16	1.2	●	336112	350
BT40-MFT30-M16-100	200.4	135	100	28	M16	1.3	●	336114	350
BT40-MFT30-M16-140	240.4	175	140	28	M16	1.6	●	336116	400
BT40-MFT35-M16-60	160.4	95	60	33	M16	1.3	●	336118	350
BT40-MFT35-M16-120	220.4	155	120	33	M16	1.7	●	336120	350
BT50-MFT16-M8-60	206.8	105	60	15	M8	3.1	●	336122	700
BT50-MFT16-M8-120	266.8	165	120	15	M8	3.2	●	336124	700
BT50-MFT20-M10-60	206.8	105	60	19	M10	3.2	●	336126	700
BT50-MFT20-M10-120	266.8	165	120	19	M10	3.3	●	336128	700
BT50-MFT25-M12-60	206.8	105	60	24	M12	3.3	●	336130	700
BT50-MFT25-M12-120	266.8	165	120	24	M12	3.4	●	336132	700
BT50-MFT30-M16-60	206.8	105	60	28	M16	3.4	●	336134	700
BT50-MFT30-M16-120	266.8	165	120	28	M16	3.5	●	336136	700
BT50-MFT35-M16-60	206.8	105	60	33	M16	3.5	●	336138	700
BT50-MFT35-M16-120	266.8	165	120	33	M16	3.7	●	336140	700

■ 整支通孔利于出水及抗震。

■ Beneficial to the entire branch water and seismic hole.

钨钢刀柄

锁牙式钨钢刀柄

Tungsten steel toolholder with locking teeth

- MFL 钨钢锁牙式刀杆
- MFL Carbide screwed end mills holder

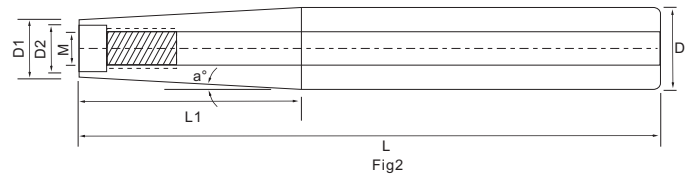
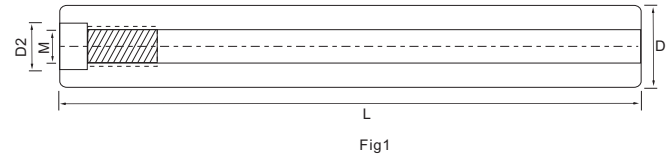

订购编码 Order Number	型号 Cat. No	Fig	L	D	D1	L1	a°	M	D2	Steel Stock	Price (RMB)	Carbide Stock	Price (RMB)
336200	MFL06-06-060-M03	1	60	6	6	-	-	M3X0.5	3.5	○	400	●	800
336202	MFL06-06-120-M03	1	120	6	6	-	-	M3X0.5	3.5	○	400	●	800
336204	MFL08-08-060-M04	1	60	8	8	-	-	M4X0.7	4.5	○	400	●	800
336206	MFL08-08-100-M04	1	100	8	8	-	-	M4X0.7	4.5	○	400	●	990
336208	MFL08-08-150-M04	1	150	8	8	-	-	M4X0.7	4.5	○	400	●	1100
336210	MFL08-10-150-M04DT60	2	150	10	7.8	60	1°	M4X0.7	4.5	○	450	○	1200
336212	MFL10-10-075-M05	1	75	10	10	-	-	M5X0.8	5.5	○	500	●	1000
336214	MFL10-10-100-M05	1	100	10	10	-	-	M5X0.8	5.5	○	500	●	1080
336216	MFL10-10-150-M05	1	150	10	10	-	-	M5X0.8	5.5	○	500	●	1290
336218	MFL10-12-150-M05DT60	2	150	12	9.8	60	1°	M5X0.8	5.5	○	550	○	1450
336220	MFL10-20-300-M05DT135	2	300	20	9.8	135	2.15°	M5X0.8	5.5	○	650	○	5500
336222	MFL12-12-075-M06	1	75	12	12	-	-	M6X1.0	6.5	○	500	●	1150
336224	MFL12-12-100-M06	1	100	12	12	-	-	M6X1.0	6.5	○	500	●	1290
336226	MFL12-12-150-M06	1	150	12	12	-	-	M6X1.0	6.5	○	500	●	1480
336228	MFL12-12-200-M06	1	200	12	12	-	-	M6X1.0	6.5	○	500	●	1980
336230	MFL12-16-150-M06DT70	2	150	16	11.8	70	1.65°	M6X1.0	6.5	○	550	○	2200
336232	MFL12-16-200-M06DT90	2	200	16	11.8	90	1.3°	M6X1.0	6.5	○	600	○	2600
336234	MFL12-16-250-M06DT115	2	250	16	11.8	115	1°	M6X1.0	6.5	○	700	○	3200
336236	MFL12-16-300-M06DT135	2	300	16	11.8	135	1.7°	M6X1.0	6.5	○	800	○	3800
336238	MFL15.6-15.6-150-M08	1	150	15.6	15.6	-	-	M8X1.25	8.5	○	500	●	1900
336240	MFL16-16-100-M08	1	100	16	16	-	-	M8X1.25	8.5	○	500	●	1980
336242	MFL16-16-150-M08	1	150	16	16	-	-	M8X1.25	8.5	○	500	●	2240
336244	MFL16-16-200-M08	1	200	16	16	-	-	M8X1.25	8.5	○	800	●	2630
336246	MFL16-16-250-M08	1	250	16	16	-	-	M8X1.25	8.5	○	900	●	3130
336248	MFL16-20-200-M08DT90	2	200	20	15.5	90	1.3°	M8X1.25	8.5	○	900	○	4000
336250	MFL16-20-250-M08DT115	2	250	20	15.5	115	1°	M8X1.25	8.5	○	950	○	4700
336252	MFL16-20-300-M08DT135	2	300	20	15.5	135	0.85°	M8X1.25	8.5	○	1000	○	5400
336254	MFL19-19-200-M10	1	200	19	19	-	-	M10X1.5	10.5	○	800	●	2600
336256	MFL20-20-100-M10	1	100	20	20	-	-	M10X1.5	10.5	○	800	●	2650
336258	MFL20-20-150-M10	1	150	20	20	-	-	M10X1.5	10.5	○	900	●	3130
336260	MFL20-20-200-M10	1	200	20	20	-	-	M10X1.5	10.5	○	1100	●	3950
336262	MFL20-20-250-M10	1	250	20	20	-	-	M10X1.5	10.5	○	1300	●	4650
336264	MFL20-20-300-M10	1	300	20	20	-	-	M10X1.5	10.5	○	1600	●	5360
336266	MFL20-20-400-M10	1	400	20	20	-	-	M10X1.5	10.5	○	1800	●	6200
336268	MFL20-25-200-M10DT90	2	200	25	19.8	90	1.6°	M10X1.5	10.5	○	2000	○	6800
336270	MFL20-25-250-M10DT115	2	250	25	19.8	115	1.25°	M10X1.5	10.5	○	2300	○	7900
336272	MFL20-25-300-M10DT135	2	300	25	19.8	135	1.1°	M10X1.5	10.5	○	2800	○	9800
336274	MFL24-24-200-M12	1	200	24	24	-	-	M12X1.75	12.5	○	1200	●	4030
336276	MFL24-24-250-M12	1	250	24	24	-	-	M12X1.75	12.5	○	1200	●	4300
336278	MFL25-25-100-M12	1	100	25	25	-	-	M12X1.75	12.5	○	1400	●	4670
336280	MFL25-25-150-M12	1	150	25	25	-	-	M12X1.75	12.5	○	1600	●	5360
336282	MFL25-25-200-M12	1	200	25	25	-	-	M12X1.75	12.5	○	2000	●	6700
336284	MFL25-25-250-M12	1	250	25	25	-	-	M12X1.75	12.5	○	2300	●	7860
336286	MFL25-25-300-M12	1	300	25	25	-	-	M12X1.75	12.5	○	2800	●	9600
336288	MFL25-25-350-M12	1	350	25	25	-	-	M12X1.75	12.5	○	3000	●	11200
336290	MFL25-32-200-M12DT90	2	200	32	24.5	90	2.3°	M12X1.75	12.5	○	2600	○	8500
336292	MFL25-32-250-M12DT115	2	250	32	24.5	115	1.75°	M12X1.75	12.5	○	3300	○	12000
336294	MFL25-32-300-M12DT135	2	300	32	24.5	135	1.5°	M12X1.75	12.5	○	4000	○	13500
336296	MFL29-29-250-M16	1	250	29	29	-	-	M16X2.0	17	○	2800	●	9300
336298	MFL32-32-150-M16	1	150	32	32	-	-	M16X2.0	17	○	2000	●	6600
336300	MFL32-32-200-M16	1	200	32	32	-	-	M16X2.0	17	○	2600	●	8500
336302	MFL32-32-250-M16	1	250	32	32	-	-	M16X2.0	17	○	3300	●	11150
336304	MFL32-32-300-M16	1	300	32	32	-	-	M16X2.0	17	○	4000	●	13400
336306	MFL32-32-350-M16	1	350	32	32	-	-	M16X2.0	17	○	4500	○	15400
336308	MFL32-32-400-M16	1	400	32	32	-	-	M16X2.0	17	○	5000	○	17500
336310	MFL42-42-250-M20	1	250	42	42	-	-	M20X2.5	21	○	4000	○	15000
336312	MFL42-42-300-M20	1	300	42	42	-	-	M20X2.5	21	○	4500	○	18000
336314	MFL42-42-400-M20	1	400	42	42	-	-	M20X2.5	21	○	5000	○	25000
336316	MFL42-42-500-M20	1	500	42	42	-	-	M20X2.5	21	○	6000	○	32000

刀杆
刀盘

直角
台肩
立
铣刀

圆角
铣刀

球头
铣刀

钻铣
刀杆

倒角
刀杆

玉米
铣刀

三
面刃
槽刀

快
进给
系列

龙门
平面
铣刀

锁
牙式
刀柄