

Alloy Shim



Cat.No	Order Number	PRICE (RMB)
MC0903	801100	60
1203	801102	70
1204	801104	70
1604	801106	100
1904	801108	140
MD1103	801110	60
1504	801112	80
1506	801114	90
MS 0903	801116	70
1204	801118	70
1504	801120	90
1904	801122	130
2504	801124	150
MT 1603	801126	50
16-S	801128	50
2204	801130	90
MV1603	801132	60
NV1603	801134	60
MW0603	801136	60
MW0804	801138	70
WW0804	801140	70
STM16R	801142	50
16L	801144	50
22R	801146	80
22L	801148	80

Double-headed Tooth Screws



Cat.No	Order Number	PRICE (RMB)
MS518	801200	20
MS519	801202	20
MS520	801204	20
MS620	801206	20
MS622	801208	20
MS625	801210	20
MS630	801212	20
MS830	801214	30

Center Pin



Cat.No	Order Number	PRICE (RMB)
CTM510	801300	30
CTM513	801302	30
CTM515-T	801304	30
CTM613	801306	30
CTM617	801308	30
CTM618-W	801310	30
CTM619	801312	30
CTM822	801314	70
CTM1022	801316	70

Turning tool platen



Cat.No	Order Number	PRICE (RMB)
HL1511	801400	50
HL1808	801402	50
HL1810	801404	50
HL1812	801406	50
HL1814	801408	50
HL2114	801410	50
HL2414	801412	50
HL1917	801414	60
HL2217	801416	60
HLT-16	801418	90
HLT-08	801420	90

Lever

Cat.No	Order Number	PRICE (RMB)
LV3	801500	100
LV4	801502	100
LV5	801504	100
LV6	801506	100
LV4B	801508	100

Lever Screw

Cat.No	Order Number	PRICE (RMB)
VHX0617	801600	36
VHX0821	801602	36
VHX0825	801604	36
VHX1027	801606	36

Spring

Cat.No	Order Number	PRICE (RMB)
SP3	801700	16
SP4	801702	16
SP5	801704	16
SP6	801706	16
SP10	801708	16

Cutter Plate

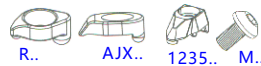

Cat.No	Order Number	PRICE (RMB)
4R	802500	24
5R	802502	24
6R	802504	24
8R	802506	30
AJX141505	802508	30
AJX141605M	802510	30
AJX121304	802512	30
1235M	802514	40
M3/16×13	802516	24
M1/4×17	802518	24
M5/16×23	802520	24

Screw



Cat.No	Order Number	PRICE (RMB)
M1.6×4	801800	10
M1.7×4	801802	10
M1.8×4	801804	10
M2.0×5	801806	10
M2.2×5	801808	10
M2.3×5	801810	10
M2.5×5	801812	10
M2.5×5.5	801814	10
M2.5×6	801816	10
M2.5×6-3.7	801818	10
M2.5×6.5	801820	10
M2.5×8	801822	10
M2.5×10	801824	10
M3.0×6	801826	10
M3.0×7	801828	10
M3.0×7-4.3	801830	10
M3.0×8	801832	10
M3.0×9-5.1	801834	10
M3.0×9.5	801836	10
M3.0×10	801838	10
M1/8×12	801840	10
M3.5×8	801842	10
M3.5×8.5	801844	10
M3.5×10-5.0	801846	10
M3.5×10	801848	10
M3.5×12	801850	10
M3.5×15	801852	10
M4.0×8	801854	10
M4.0×9	801856	10
M4.0×9-5.0	801858	10
M4.0×9-7.0	801860	10
M4.0×10	801862	10
M4.0×12	801864	10
M4.0×11-5.0	801866	10
M4.0×14	801868	10
M4.0×16	801870	10
M4.0×16-7.0	801872	10
M4.5×11	801874	10
M4.5×12.5	801876	10
M4.5×16	801878	10
M3/16×12.5-9.5	801880	10
M5.0×11	801882	10
M5.0×12	801884	10
M5.0×16-P	801886	10
M6.0×18	801888	10
Inner six angle screw		
MS4.0×17	801890	10
MS5.0×20	801892	10
MS5.0×25	801894	10
MS6.0×20	801896	10
MS6.0×25	801898	10
Side screw		
M3×8C	801900	10

Flag Wrench

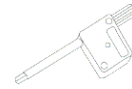

Cat.No	Order Number	PRICE (RMB)
T6	801900	20
T7	801902	20
T8	801904	20
T9	801906	20
T10	801908	20
T15	801910	20
T20	801912	20

T-box End Wrench



Cat.No	Order Number	PRICE (RMB)
TT8	802100	70
TT10	802102	70
TT15	802104	70
TT20	802106	70
TT25	802108	80
TT30	802110	80

Straight shank End Wrench

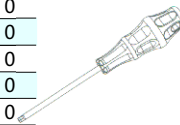

Cat.No	Order Number	PRICE (RMB)
IT5	802200	70
IT6	802202	70
IT7	802204	70
IT8	802206	70
IT10	802208	70
IT15	802210	70
IT20	802212	70
IT25	802214	80
IT30	802216	80

Allen Wrench



Cat.No	Order Number	PRICE (RMB)
PL2	802300	3.4
PL2.5	802302	4.0
PL3	802304	4.8
PL4	802306	6.4
PL5	802308	9.0

T-hex Wrench



Cat.No	Order Number	PRICE (RMB)
TL2	802400	70
TL2.5	802402	70
TL3	802404	70
TL4	802406	70
TL5	802408	80
TL6	802410	90
TL8	802412	100

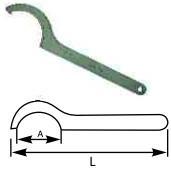

C/OZ-Spanner



ER-A-Spanner

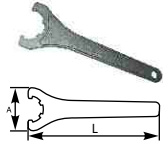

ER-UM-Spanner

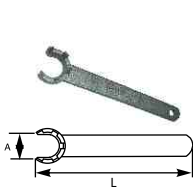

ER-M-Spanner

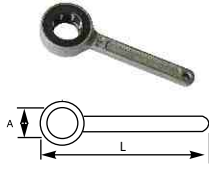

GER/GSK-Spanner

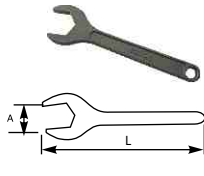

SK-Spanner

C-SPANNER

Cat.No	A	L	Weight (KG)	PRICE (RMB)
BSC20	55-55	245	0.17	120
BSC25	56-61	270	0.2	120
BSC32	68-73	290	0.3	120
BSC42	88-96	340	0.42	120

OZ-SPANNER

BSOZ25	55-60	250	0.24	80
--------	-------	-----	------	----

ER-SPANNER

BSER11A	17.2	120	0.10	100
BSER16A	25.2	140	0.15	100
BSER20A	30.3	160	0.19	100
BSER8M	12	75	0.05	100
BSER11M	16	95	0.04	100
BSER16M	22	117	0.06	100
BSER20M	28	129	0.07	100
BSER25M	35	142	0.09	100
BSER25UM	42	210	0.15	110
BSER32UM	50	250	0.28	120
BSER40UM	64	290	0.42	130

GER-SPANNER

BSGER16,BSGER16MINI	30,25	150	0.24	300
BSGER20,BSGER20MINI	35,30	160	0.30	300
BSGER25,BSGER25MINI	40,35	180	0.35	300
BSGER32	50	180	0.70	400

GSK-SPANNER

BSGSK6	19.5	110	0.11	400
BSGSK10	27.1	150	0.29	300
BSGSK16	40	170	0.39	400
BSGSK25	55	210	0.38	400

SK-SPANNER

BSTSK6	18.2	175	0.11	200
BSTSK10	25.2	175	0.12	152
BSTSK16	40	220	0.15	228
BSTSK25	55	230	0.17	304

ER-A-Clamping Nut

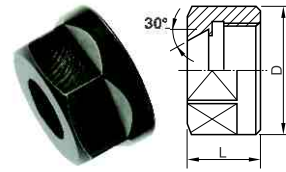

ER-M-Clamping Nut

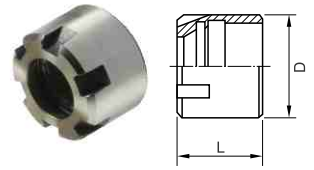

ER-UM-Clamping Nut

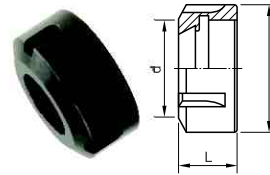

GER/GSK-Clamping Nut

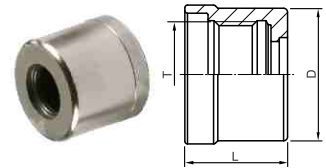

SK-Clamping Nut

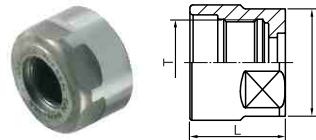

ER CLAMPING NUT

Cat.No	D	L	Spanner	PRICE (RMB)
LMER11A	19	11.5	BSER11A	100
LMER16A	28	17.5	BSER16A	100
LMER20A	34	19.0	BSER20A	100
LMER8M	12	108	BSER8M	100
LMER11M	16	12.0	BSER11M	100
LMER16M	22	18	BSER16M	100
LMER20M	28	19.0	BSER20M	100
LMER25M	35	20.0	BSER25M	100
LMER25UM	42	20.0	BSER25UM	100
LMER32UM	50	22.5	BSER32UM	110
LMER40UM	64	25.5	BSER40UM	120
LMER50UM	78	35.3	BSER50UM	150

GER CLAMPING NUT

LMGER16,LMGER16MINI	30,25	21	BSGER16,BSGER16MINI	120
LMGER20,LMGER20MINI	35,30	21.8	BSGER20,BSGER20MINI	130
LMGER25,LMGER25MINI	40,35	23	BSGER25,BSGER25MINI	140
LMGER32	50	35	BSGER32	180
LMGSK6	19.5	21.3	BSGSK6	260
LMGSK10	27.1	24.2	BSGSK10	200
LMGSK16	40	31	BSGSK16	350
LMGSK25	55	37.5	BSGSK25	420

SK CLAMPING NUT

LMTSK6	19.5	15	BSTSK6	200
LMTSK10	27.5	17	BSTSK10	152
LMTSK16	40	24.3	BSTSK16	228
LMTSK25	55	37	BSTSK25	304

BT-PULLER BOLT

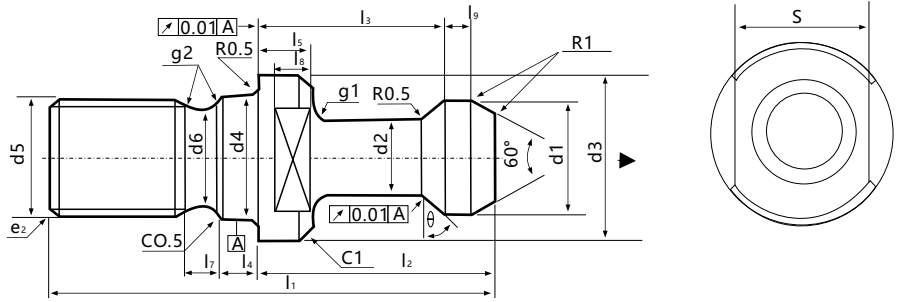

Order Number	Type	D	d	d1	d2	L	e	G	Q	Shape	Remarks	Price
809600	PS-1	15	23	17	10	60	35	M16	45	BT40-1标准型	MAS P40T-1	40
809602	PS-2	19	31	21	14	7	40	M20	60	BT40-2标准型	MAS P40T-2	40
809604	PS-3	23	38	25	17	85	45	M24	45	BT45-1标准型	MAS P45T-1	50
809606	PS-4	11	16.5	12.5	7	43	23	M12	60	BT45-2标准型	MAS P45T-2	50
809608	PS-5	13	20				28		45	BT50-1标准型	MAS P50T-1	80
809610	PS-6						45		60	BT50-2标准型	MAS P50T-2	80
809612	PS-16								45	BT30-1标准型	MAS P30T-1	40
809614	PS-17								60	BT30-2标准型	MAS P30T-2	40
809616	PS-18				8.5	48			45	BT35-1标准型	MAS P35T-2	50
809618	PS-19								60	BT35-2标准型	MAS P35T-2	50
809620	PS-5F			28		85		M24	45	BT50-1	PS-5 端面研磨	90
809622	PS-6F				17				60	BT50-2	PS-6 端面研磨	90
809624	PS-50	23	38			110	70		45	BT50		90
809626	PS-53			26.187		85.2	45.2	1-8UNC				90
809628	PS-63			26		82.5	45	1-8UNC	60	CAT50U		90
809630	PS-70	19	23	17	14	60	35	M16		BT40		40
809632	PS-72	15		16.281	10	57.15	32.15	5/8-11UNC	45	CAT40U		40
809634	PS-0	23	38	25	17	85	45	M24		BT50-90型		90
809636	PS-08-1	15	23	17	10	60	35	M16		BT40-90型		50
809638	PS-P	24	36	25	18	71	31	M24	90	BT50三井精机		90
809640	PS-P5-1	15	23	17	10	50	25	M16		BT40三井精机		50
809642	PS-P10	11	16	12.5	7	40	20	M12		BT30三井精机		40
809644	PS-U2	13.7	20	13	8.9	53	28		60	BT35松浦机械		50
809646	PS-G4	23	38	25	17	85	45	M24		BT50马扎克		90
809648	PS-G5	15	23	17	10	54.6	29.6	M16	90	BT40马扎克		50
809650	PS-G45	28.956	37	25	20.828	65.2	25.2	M24		BT50马扎克端面研磨	PS-G41无孔	100
809652	PS-G58	18.796	22	17	12.446	44.1	19.106	M16	45	BT40马扎克端面研磨	PS-G51无孔	80
809654	PS-G60	18.796	21.8	16.281	12.446	41.256	16.256	5/8-11UNC		CAT40U大隈		60
809656	PS-O19			-	17	85	45.2	1-8UNC		CAT50U		90
809658	PS-O47	23	38	25	17	85	45	M24	90	IT50森精机		90
809660	PS-P13	24	36	-	18	71	31	1-8UNC		CAT50U 三井精机		90
809662	PS-H30	15	23	16.281	10	57.2	32.2	5/8-11UNC	45	CAT40U 日立精机		60
809664	PS-B1	22	38	25	16	112	72		60	BT50 大隈		90
809666	PS-809	28			21	74	34	M24		BT50 端面研磨	JIS-B6339-89	90
809668	PS-805	19	23	17	14	54	29	M16	75	BT40 端面研磨	JIS-B6339-89	60
809670	PS-801	12	16.5	12.5	8	43	23.4			BT30 端面研磨	JIS-B6339-89	50
809672	PS-J	14	20	13		45	23		90	BT35 北村机械		60
809674	PS-M10	14	16	12.5	10	40	22	M12		CAT30S 牧野精机		50
809676	PS-R3	10	18	13	7	43	25		45	BT35 碌碌产业		80
809678	PS-C	21	39	25	15	105.1	63.1	M24		BT50 日立精工		90
809680	PS-301	15	23	17	11	60	35	M16	60	BT40 津上		40
809682	PS-Q3	16	16.5	12.5	12.5	31.8	11.8	M12	45	BT30		40
809684	PS-BR*1	7	10	6.5	4	28	17	M6	45	BT15 兄弟工业		90
809686	PS-81	12	16.5	12.5	8	44	24	M12	R4	BT30 CKD用		50
809688	PS-581	28	36	25	21	74	34	M24		IT50	DIN69872-B-1988	90
809690	PS-302	19	23	17	14	54	26	M16	75	IT40	DIN69872-A-1988	70
809692	PS-122	13	17	13	9	44	24	M12		IT30	DIN69872-A-1988	60
809694	PS-S27	18.95	22.5	17	12.95	44.25	19.25	M6	45	BT40新日本工机		50

*The center passes the oil-type engine bed when uses the non-center bore puller bolt.

*PS-814 abolishes the unification to use PS-805

*PS-P5 abolishes the unification to use PS-P5-1

*PS-08 abolishes the unification to use PS-08-1

*puller bolt body makes and the PS-BR puller bolt recommendation uses BT15 thin pole hillt P37

*When needs to attach ID the puller bolt, please at model add-on ID table demonstration:PS-6-IDB

Puller bolt

The center passes the oil-type puller bolt

Order Number	Type	Specification	Machine tool factory	d3	FIG	Remarks	Price	
809700	PS-130E	BT30-MAS-II特殊	兄弟工业东注精机工业	2.5	1	d2=7.5	60	
809702	PS-132	BT30-MAS-I特殊	FANUC法那克	4	1	d2=8	60	
809704	PS-802	BT31-JIS-B6339-89		4	1	PS-801带孔	60	
809706	PS-876	BT30 JIS型	山崎马扎克	2.5	2	d4=5.5 o=30	60	
809708	PS-73	BT40-MAS-I型		4	1	PS-1带孔	70	
809710	PS-371	BT40-MAS-I型	大隈丰和	3	2	d4=7 o=30	70	
809712	PS-392	BT40-MAS-I型	丰田工机	3	3	d4=7.3	0	
809714	PS-H28	BT40-MAS-I型	日立精机	3	3	d4=5	70	
809716	PS-75*1	BT44-MAS-II型		4	1	PS-2带孔	70	
809718	PS-806-1	BT40-JIS型	牧野制作所	6	1	PS-805 6带孔	70	
809720	PS-813-1			6	1	AS568-015带O型密封圆环	70	
809722	PS-854		安田工业	6	1	3带风孔	70	
809724	PS-874			6	2	d4=10 o=30	70	
809726	PS-877		JTEKT	3	3	d4=7.3	70	
809728	PS-B62-1		大隈	4	1	S15带O型密封圆环	70	
809730	PS-366E-1		BT40 中心能孔	森精机制作所	7	2	d4=10 o=30 N29104*3	70
809732	PS-G51		BT40 ANSI型	山崎马扎克	7	1	PS-G58 带孔34931900680*2	70
809734	PS-G510	7			3	PS-G51高压型34261910160*2	70	
809736	PS-309	IT40 DIN型	森精机制作所	7	1	DIN 69872-A-1988	80	
809738	PS-380E	IT40 DIN型中心通孔		7	2	d4=10 o=30 N29106*3	80	
809740	PS-A1	IT40 ISO A型		7	1	ISO-7388/2-1984A	80	
809742	PS-A4	IT40 ISO B型		7.35	1	ISO-7388/2-1984B	80	
809744	PS-G52	IT40 ANSI型		7	1	34931900660*2	80	
809746	PS-G53	CAT40U ANSI型		7	1	34931900670*2	80	
809748	PS-B64-1	CAT40U ANSI型		大隈	4	1	S15带O型密封圆环	80
809750	PS-D72	CAT40U ANSI型		7	1	ANSI/ASME B5,50-1985	80	
809752	PS-381E	CAT40U 中心通孔	森精机制作所	7	2	d4=10 o=30 N29105*3	80	
809754	PS-5E	BT50-MAS-I型		6	1	PS-5带孔	100	
809756	PS-552	BT50-MAS-I型	丰田工机	6	3	d4=10.4	100	
809758	PS-563		安田工业	5.5	2	d4=11.2 o=60	100	
809760	PS-595		森精机制作所	8	2	d4=11 o=30 N29120*3	100	
809762	PS-5024		大隈丰和	6	2	d4=9.5 o=30	100	
809764	PS-5027		大阪机工	6	4	端面附带O型密封圆环	100	
809766	PS-5030G		东芝机械	4.5	1	带O型密封圆环	100	
809768	PS-M16		牧野制作所	6	1	带O型密封圆环	100	
809770	PS-H38-B		日立精机	3	4	端面附带O型密封圆环	100	
809772	PS-6E	BT50-MAS-II型	日立精机	6	1	PS-6带孔	100	
809774	PS-578	BT50-MAS-II型	丰田工机	6	3	d4=10.4	100	
809776	PS-579		安田工业	5.5	2	d4=11.2 o=60	100	
809778	PS-596		森精机制作所	8	2	d4=11 o=30 n29126*3	100	
809780	PS-5016		大隈丰和	6	2	d4=9.5 o=30	100	
809782	PS-B60		大隈	6	1	带O型密封圆环	100	
809784	PS-H39-B		日立精机	3	4	端面附带O型密封圆环	100	
809786	PS-O31		BT50 90型	日立精机	6	1	PS-O穴付	100
809788	PS-O56			森精机制作所	8	2	d4=11 o=30 N29119*3	100
809790	PS-O67	大阪机工	6	4	端面附带O型密封圆环	100		
809792	PS-O48-B	日立精机	3	4	端面附带O型密封圆环	100		
809794	PS-810	BT50 JIS-B6339-89	日立精机	10	1	PS-809带孔	100	
809796	PS-819	丰田工机	6	3	d4=10.4	100		
809798	PS-833	BT50 JIS型	安田工业	5.5	2	d4=11.2 o=60	100	
809800	PS-816-1	牧野制作所	6	1	P21带O型密封圆环	100		
809802	PS-P16	BT50 三井精机专用	三井精机	8	1	PS-P带孔端面研磨	100	
809804	PS-G41	BT50 ANSI型	山崎马扎克	10	4	端面附带O型密封圆环44831901160*2	100	
809806	PS-G63			10	1	PS-G45带孔端面研磨32551901720*2	100	
809808	PS-G410			10	3	PS-G41高压规格34341901620*2	100	
809810	PS-D92			CAT50U ANSI型	11.7	1	ANSI/ASME B5,50-1985	100
809812	PS-A3	IT50 ISO A型	11.5	1	ISO-7388/2-1984A	100		
809814	PS-A6	IT50 ISO B型	11.55	1	ISO-7388/2-1984B	100		
809816	PS-512	IT50 DIN型	11.5	1	DIN 69872-A-1988	100		



◆ High accuracy: **0.005mm**

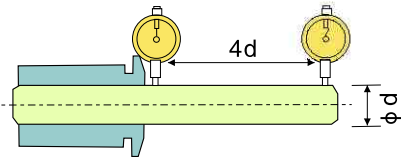

0.005mm

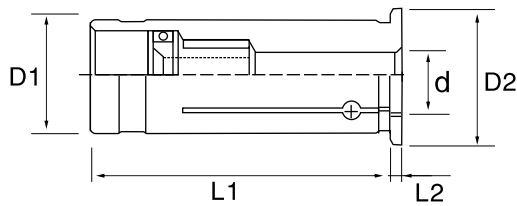

■ HM HYDRAULIC COLLET

Cat.No	D1	D2	L1	L2	d	Order Number	PRICE (RMB)				
HM12-3	12	16	44.5	2	3	803100	700				
-4					4	803102	700				
-5					5	803104	700				
-6					6	803106	700				
-7					7	803108	700				
-8					8	803110	700				
-10					10	803112	700				
HM20-3					20	24	50.5	2	3	803114	700
-4									4	803116	700
-5									5	803118	700
-6	6	803120	700								
-7	7	803122	700								
-8	8	803124	700								
-9	9	803126	700								
-10	10	803128	700								
-11	11	803130	700								
-12	12	803132	700								
-13	13	803134	700								
-14	14	803136	700								
-15	15	803138	700								
-16	16	803140	700								
-17	17	803142	700								
-18	18	803144	700								
HM32-6	32	36	60.5	3	6	803146	850				
-8					8	803148	850				
-10					10	803150	850				
-12					12	803152	850				
-14					14	803154	850				
-16					16	803156	850				
-18					18	803158	850				
-20					20	803160	850				
-25					25	803162	850				

※ Uses the straight body design
 ※ Is suitable for the hydraulic pressure hilt

■ OHM 0.003mm OHM THROUGH OIL-BASED HYDRAULIC COLLET

Cat.No	D1	D2	L1	L2	d	Order Number	PRICE (RMB)				
OHM12-3	12	19	45	2	3	803200	950				
-4					4	803202	950				
-5					5	803204	950				
-6					6	803206	950				
-7					7	803208	950				
-8					8	803210	950				
-10					10	803212	950				
OHM20-3					20	29	50.5	2	3	803214	950
-4									4	803216	950
-5									5	803218	950
-6	6	803220	950								
-7	7	803222	950								
-8	8	803224	950								
-9	9	803226	950								
-10	10	803228	950								
-11	11	803230	950								
-12	12	803232	950								
-13	13	803234	950								
-14	14	803236	950								
-15	15	803238	950								
-16	16	803240	950								
-17	17	803242	950								
-18	18	803244	950								
OHM32-6	32	39	60.5	3	6	803246	1150				
-8					8	803248	1150				
-10					10	803250	1150				
-12					12	803252	1150				
-14					14	803254	1150				
-16					16	803256	1150				
-18					18	803258	1150				
-20					20	803260	1150				
-25					25	803262	1150				

■ C TYPE MILLING COLLET

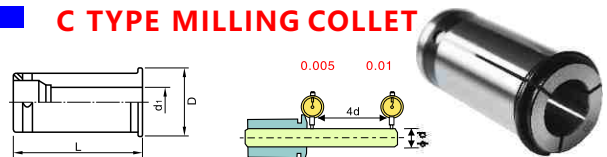

Style	Cat.No	D	L	Order Number	PRICE (RMB)
C20	C20-3,4,5,6,8,10,12,16	26	55.1	803300	100
C25	C25-3,4,5,6,8,10,12,16,20	30	63	803302	120
C32	C32-3,4,5,6,7,8,9,10,12,16,20,25	38	70	803304	140
C42	C42-3,4,6,8,10,12,16,20,25,32	48	75	803308	200
C42	C42-1/4,5/16,3/8,1/2,5/8,3/4,1,1-1/4"	48	75	803310	200

■ MX COLLET

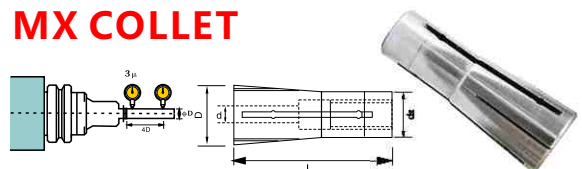

Style	Cat.No	Precision		D	L	Order Number	PRICE (RMB)
		Standard	Micron				
MX6	MX6-2,3,4,5,6,3,175	0.005	0.003	9.6	36	803400	680
MX10	MX10-3,4,5,6,8,10	0.005	0.003	16	52	803402	680
MX12	MX12-3,4,5,6,8,10,12	0.005	0.003	22	57	803404	680

ER SPRING COLLET

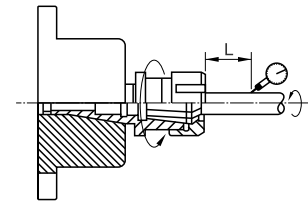

Cat.No	Order Number	PRICE (RMB)
ER8-1,1.5,2,2.5,3,3.5,4,4.5,5		100
ER11-1,1.5,2,2.5,3,3.5,4,4.5,5,5.5,6,6.5,7		100
ER16-1,1.5,2,2.5,3,3.5,4,4.5,5,5.5,6,6.5,7,7.5,8,8.5,9,9.5,10		100
ER20-1,1.5,2,2.5,3,3.5,4,4.5,5,5.5,6,6.5,7,7.5,8,8.5,9,9.5,10,10.5,11,11.5,12,12.5,13		100
ER25-1,2,3,4,5,6,7,8,9,10,11,12,13,14,15,16		105
ER32-1,2,3,4,5,6,7,8,9,10,11,12,13,14,15,16,17,18,19,20,21,22		110
ER40-2,3,4,5,6,7,8,9,10,11,12,13,14,15,16,17,18,19,20,21,22,23,24,25,26,27,28		120
ER50-12,14,16,18,20,22,24,26,28,30,32,34		350

SK SPRING COLLET

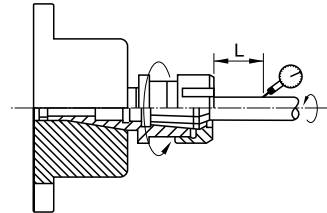
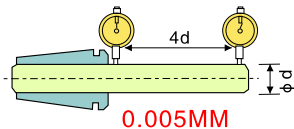

Cat.No	Order Number	PRICE (RMB)
SK6-0.8,1,1.25,1.5,1.75,2,2.25,2.5,2.75,3,3.5,4,4.5,5,5.5,6	803500	420
SK10-2,2.25,2.5,2.75,3,3.5,4,4.5,5,5.5,6,6.5,7,7.5,8,8.5,9,9.5,10	803502	350
SK16-3,3.5,4,4.5,5,5.5,6,6.5,7,7.5,8,8.5,9,9.5,10,10.5,11,11.5,12,12.5,13,13.5,14,14.5,15,15.5,16	803504	350
SK20-3,4,5,6,8,10,12,16,20	803506	350
SK25-6,8,10,12,14,16,16.5,17,17.5,18,18.5,19,19.5,20,20.5,21,21.5,22,22.5,23,23.5,24,24.5,25,25.4	803508	380

OZ SPRING COLLET

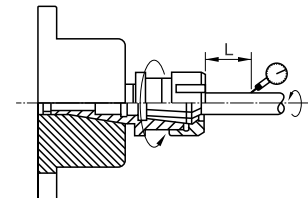
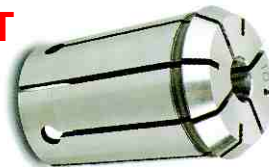

Cat.No	Order Number	PRICE (RMB)
OZ25-3,4,5,6,7,8,9,10,11,12,13,14,15,16,17,18,19,20,21,22,23,24,25	803700	10
OZ32-3,4,5,6,7,8,9,10,11,12,13,14,15,16,17,18,19,20,21,22,23,24,25,26,27,28,29,30,31,32	803702	

ERZ Sealed Collets

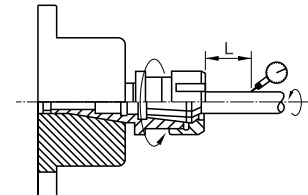

Cat.No	Order Number	PRICE (RMB)
ERZ16-4, 5, 6, 7, 8, 9, 10	803800	
ERZ20-4, 5, 6, 7, 8, 9, 10, 11, 12	803802	
ERZ25-4, 5, 6, 7, 8, 9, 10, 11, 12, 13, 14, 15, 16	803804	
ERZ32-4, 5, 6, 7, 8, 9, 10, 11, 12, 13, 14, 15, 16, 18, 20	803806	
ERZ40-4, 5, 6, 7, 8, 9, 10, 11, 12, 13, 14, 15, 16, 18, 20, 25	803808	



TC TC QUICK CHANGE TAP COLLET

Style	Cat.No	Order Number	PRICE (RMB)
TC1638	TC1638-M14,M15,M16,M17,M18,M20,M22,M24,M25,M26,M27,M28,M30,M32,M33,M34,M35,M36 -UNC9/16,UNC5/8,UNC3/4,UNC7/8,UNC1,UNC1-1/8,UNC1-1/4,UNC1-3/8 -PT1/4,PT3/8,PT1/2,PT3/4,PT1	804000	600
	TC822-M7,M8,M9,M10,M11,M12,M14,M15,M16,M17,M18,M20,M22 -UNC3/8,7/16,1/2,9/16,5/8,3/4,7/8 -PT1/8,PT1/4,PT3/8,PT1/2		
TC822	TC822-M7,M8,M9,M10,M11,M12,M14,M15,M16,M17,M18,M20,M22 -UNC3/8,7/16,1/2,9/16,5/8,3/4,7/8 -PT1/8,PT1/4,PT3/8,PT1/2	804002	450
	TC312-M3,M4,M5,M6,M7,M8,M9,M10,M11,M12,M14,M15 -UNC1/4,UNC5/16,UNC3/8,UNC7/16,UNC1/2,UNC9/16 -PT1/8,PT1/4		
TC312	TC312-M3,M4,M5,M6,M7,M8,M9,M10,M11,M12,M14,M15 -UNC1/4,UNC5/16,UNC3/8,UNC7/16,UNC1/2,UNC9/16 -PT1/8,PT1/4	804004	300

* Buy this product please indicate the collet is a square hole and the circular hole or brand silk attack or reference standard.

ERT Tapping Collets

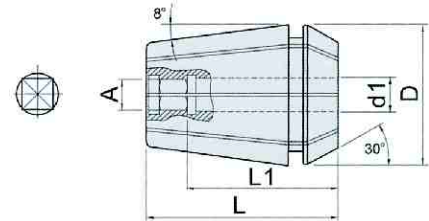

ERT SCREW ACCORDING TO THE STANDARD OF 1 GRADE PRECISION COLLET (10 MICRON) MANUFACTURING.

ERT16 Collets

D=16.5/L=27.5

The utility model is suitable for both the standard ER chuck and the wire tapping chuck. (depending on the specific shank diameter and square size).

Order No.	Model	d1	Tapping specification		Tapping square Size A-□mm	L1	Price
			DIN371	DIN376			
804200	ERT 16045	4.5	M4	M6	3.4	18	
804202	ERT 16050	5	ISO	JIS	4	18	
804204	ERT 16055	5.5		M7	4.5	18	
804206	ERT 16060	6	M4.5-M5-M6	M8	4.9	18	
804208	ERT 16070	7	M7	M9-M10	5.5	18	

ERT20 Collets

D=20.5/L=32.5

Order No.	Model	d1	Tapping specification		Tapping square Size A-□mm	L1	Price
			DIN371	DIN376			
804300	ERT 20045	4.5	M4	M6	3.4	18	
804302	ERT 20050	5	ISO	JIS	4	18	
804304	ERT 20055	5.5		M7	4.5	18	
804306	ERT 20060	6	M4.5-M5-M6	M8	4.9	18	
804308	ERT 20070	7	M7	M9-M10	5.5	18	
804310	ERT 20090	8	M8	M11	6.2	22	
804312	ERT 20100	9	M9	M12	7	22	
804314	ERT 20110	10	M10		8	25	

ERT25 Collets

D=25.5/L=34

Order No.	Model	d1	Tapping specification		Tapping square Size A-□mm	L1	Price
			DIN371	DIN376			
804400	ERT 25045	4.5	M4	M6	3.4	18	
804402	ERT 25050	5	ISO	JIS	4	18	
804404	ERT 25055	5.5		M7	4.5	18	
804406	ERT 25060	6	M4.5-M5-M6	M8	4.9	18	
804408	ERT 25070	7	M7	M9-M10	5.5	18	
804410	ERT 25080	8	M8	M11	6.2	22	
804412	ERT 28090	9	M9	M12	7	22	
804414	ERT 25100	10	M10		8	25	
804416	ERT 25110	11		M14	9	25	
804418	ERT 25120	12	M12	M16	9	25	

ERT32 Collets

ERT SCREW ACCORDING TO THE STANDARD OF 1 GRADE PRECISION COLLET (10 MICRON) MANUFACTURING.

The utility model is suitable for both the standard ER chuck and the wire tapping chuck.
(depending on the specific shank diameter and square size).

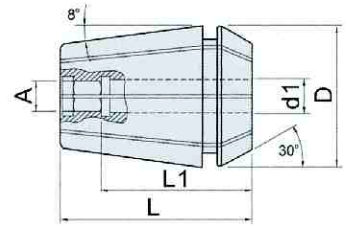

D=32.5/L=40

Order No.	Model	d1	Tapping specification		Tapping square Size A-□mm	L1	Price
			DIN371	DIN376			
804600	ERT 32045	4.5	M4	M6	3.4	18	
804602	ERT 32050	5	ISO	JIS	4	18	
804604	ERT 32055	5.5		M7	4.5	18	
804606	ERT 32060	6	M4.5-M5-M6	M8	4.9	18	
804608	ERT 32070	7	M7	M9-M10	5.5	18	
804610	ERT 32080	8	M8	M11	6.2	22	
804612	ERT 32090	9	M9	M12	7	22	
804614	ERT 32100	10	M10		8	25	
804616	ERT 32110	11		M14	9	25	
804618	ERT 32120	12	M12	M16	9	25	
804620	ERT 32140	14		M18	11	25	
804622	ERT 32160	16		M20	12	25	

ERT40 Collets

D=40.5/L=46

Order No.	Model	d1	Tapping specification		Tapping square Size A-□mm	L1	Price
			DIN371	DIN376			
804800	ERT 40060	6	M4.5-M5-M6	M8	4.9	18	
804802	ERT 40070	7	M7	M9-M10	5.5	18	
804804	ERT 40080	8	M8	M11	6.2	22	
804806	ERT 40090	9	M9	M12	7	22	
804808	ERT 40100	10	M10		8	25	
804810	ERT 40110	11		M14	9	25	
804812	ERT 40120	12	M12	M16	9	25	
804814	ERT 40140	14		M18	11	25	
804816	ERT 40160	16		M20	12	25	
804818	ERT 40170	17		JIS	13	33	
804820	ERT 40180	18		M22-M24	14.5	33	
804822	ERT 40200	20		M27	16	33	
804824	ERT 40220	22		M30	18	33	

ERT SCREW ACCORDING TO THE STANDARD OF 1 GRADE PRECISION COLLET (10 MICRON) MANUFACTURING.

SPINDLE TAPER WIPER



Style	Weight(KG)	PRICE (RMB)
BT30	0.05	200
BT40	0.06	200
BT50	0.13	250

TEST BAR



Style	D	L	Concentricity	PRICE (RMB)
BT30-TA250L	32	250	±0.003	3300
BT40-TA300L	40	300		3800
BT50-TA300L	40	300		4200
SKT40-TA300L	40	300		4200
SKT50-TA300L	40	300		4550
CAT30-TA250L	32	250		3200
CAT40-TA300L	40	300		3600
CAT50-TA300L	40	300		4000
HSK63A-TA300L	40	400		7600

TOLL LOCKING FIXTURE



Style	Toll Locking fixture		BT toll locking fixture		Locks the tool apron without the key slot		HSK toll locking fixture	
	TYPE	PRICE	TYPE	PRICE	TYPE	PRICE	TYPE	PRICE
Cat. No	BT30	600	XBT30	750	ISO20-33	2000	HSK40	2000
	BT40	600	XBT40	750	ISO25-37	2300	HSK50	2300
	BT50	800	XBT50	1000	ISO30-50	2300	HSK63	2300
	CAT30	1100			NBT30-46	2300	HSK100	3200
	CAT40	1200						
	CAT50	1450						

Setting High:50mm



Model No	Fig	Stting High	Price
ZIP50A	1	50mm±0.005	1600
ASM50	2	50mm±0.005	2400
ZAP50	3	50mm±0.005	2960
ASM100	4	100mm±0.005	1800
SM100	5	100mm±0.005	3000

- Easy,quick,simple for setting tool length on the machine center
- Base with magnetic

3D-SENSORS-HAIMER



Model No	HAIMER	ACCURACY	CLAMPING SHANK	PRICE
3D-Sensors	80.360.00	0.01mm	20mm	
3D-Short Needle	80.362.00	0.01mm	20mm	
3D-long Needle	80.363.00	0.01mm	20mm	

EDGE FINDER



MECHANICAL EDGE FINDER

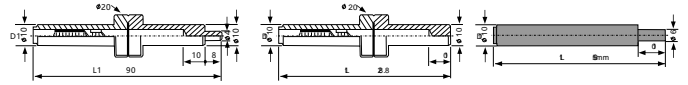

Model No	FIG	D1	L1	PRICE
FM10-FIG.1	1	10	90	160
FM10-FIG.2	2	10	82.8	160
ME-610	3	10	65	160

CERAMIC EDGE FINDER

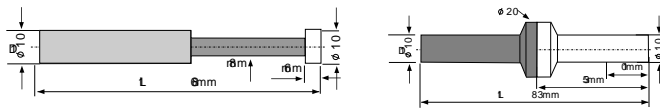

Model No	FIG	D1	L1	PRICE
SH-1020	1	10	86	280
WH-1020	2	10	83	280

ROTARY DEGE FINDER-ME-P1 + P2-

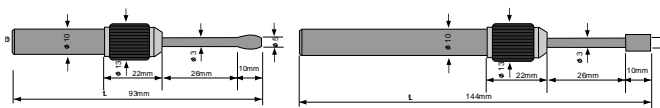

Model No	FIG	D1	L1	PRICE
ME-P1	1	10	93	260
ME-P2	2	10	144	280
ME-P1 + P2	3			300

RM20/PM32-Photoelectric edge finder

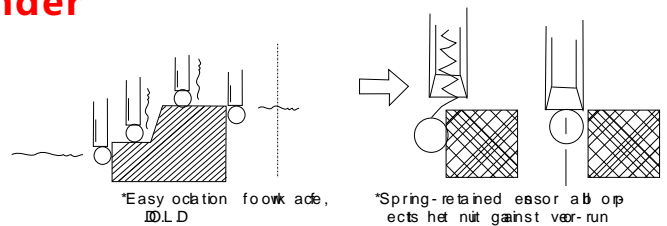
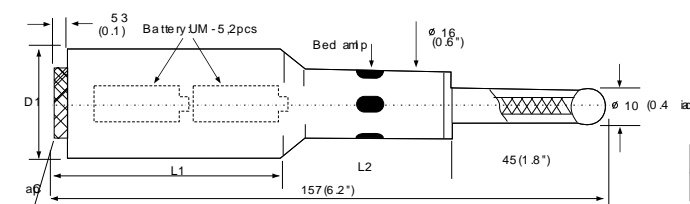

Model No	D1	L1	L2	PRICE
PM20	20	77	35	360
PM32	32	71	41	460

RM3/4",PM1-1/4-Photoelectric edge finder

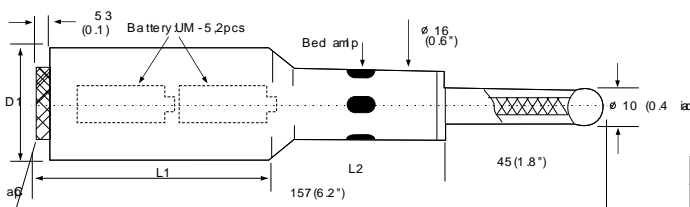

Model No	FIG	D1	L1	PRICE
PM3/4"	19.05(3/4)	77	35	360
PM1-1/4	31.75(1-1/4")	71	41	460

TOOL STAND

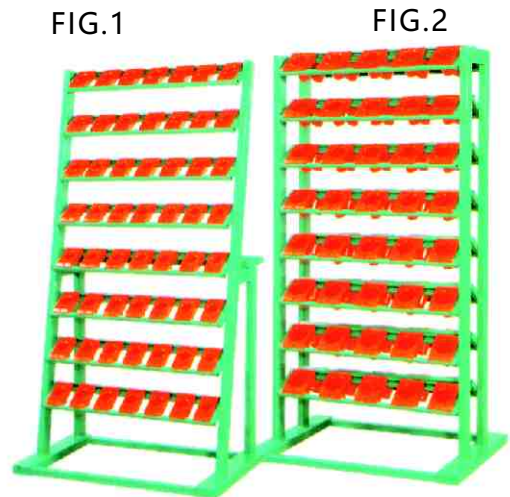

Order Number	Model No	Shank Size	Tool Capacity	Price
806100	#30 TOOL STAND-FIG.1	BT/NT/CAT/NC30	64 PCS	64 PCS
806102	#40 TOOL STAND-FIG.1	BT/NT/CAT/NC40	56 PCS	56 PCS
806104	#50 TOOL STAND-FIG.1	BT/NT/CAT/NC50	40 PCS	40 PCS
806106	#30 TOOL STAND-FIG.2	BT/NT/CAT/NC30	128 PCS	128 PCS
806108	#40 TOOL STAND-FIG.2	BT/NT/CAT/NC40	112 PCS	112 PCS
806110	#50 TOOL STAND-FIG.2	BT/NT/CAT/NC50	80 PCS	80 PCS

TOOL SHEATH

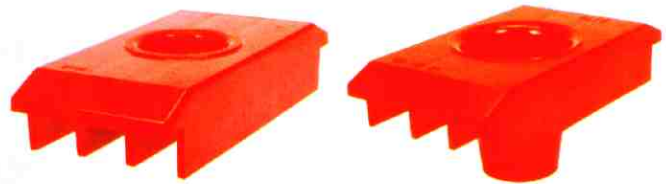

Order Number	Model No	Size	Shank Size	Price
806200	#30 TOOL SHEATH	64Wx137Dx48HMM	BT/NT/CAT/NC30	
806202	#40 TOOL SHEATH	74Wx137Dx63HMM	BT/NT/CAT/NC40	
806204	#50 TOOL SHEATH	104Wx137Dx93HMM	BT/NT/CAT/NC50	

TOOL TROLLEY

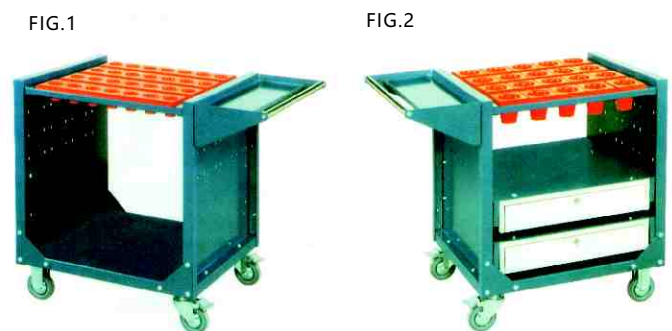

Order Number	Model No	Shank Size	TOOL Capacity	Drawer	Price
806300	#30 TOOL TROLLEY-FIG.1	BT/NT/CAT/NC30	32PCS	X	
806302	#40 TOOL TROLLEY-FIG.1	BT/NT/CAT/NC40	28PCS	X	
806304	#50 TOOL TROLLEY-FIG.1	BT/NT/CAT/NC50	20PCS	X	
806306	#30 TOOL TROLLEY-FIG.2	BT/NT/CAT/NC30	32PCS	2-SET	
806308	#40 TOOL TROLLEY-FIG.2	BT/NT/CAT/NC40	28PCS	2-SET	
806310	#50 TOOL TROLLEY-FIG.2	BT/NT/CAT/NC50	20PCS	2-SET	

TC-Special purpose tool cart

TC-S23
570Wx345Dx650HMM
(His not inciuding wheel-160mm)

Suitable for narrow site

S type mini tool vehicle

	W	D	H
Small	480	292	75
Big	480	290	154

Unit:mm



TC-LT25
680Wx460Dx830Hmm
(Hisnot including wheel-160mm)

Increased area tool cart

L type large tool car

	W	D	H
Small	569	398	73

Big	569	398	153
-----	-----	-----	-----

Unit:mm

* landing tool vehicle, wheel design, easy to move,
Drawer are equipped with steel ball slide, smooth pulling
* each pumping can carry 40KG
Central control drawer with safety lock
* strong body bearing strong love
* standard "super resistance" to "wheels" of all sizes
* powder paint body, abrasion resistance and solvent erosion

CK-CLAMPING KIT 52-PCS STEEL CLAMPING KIT

Order Number	Model No	Table Slot(T-slot)	Stud Size	Price
806400	CK-103A	7/16"	3/8"-16NC	
806402	CK-103B	1/2"	3/8"-16NC	
806404	CK-104A	9/16"	1/2"12NC	
806406	CK-104B	5/8"	1/2"12NC	
806408	CK-104C	9/16"	1/2"13NC	
806410	CK-105A	11/16"	5/8"-11	
806412	CK-105B	3/4"	5/8"-11	
806414	CK-08	10	M08x1.25P	
806416	CK-10	12	M10x1.50P	
806418	CK-12A	14	M12x1.75P	
806420	CK-12B	16	M12x1.75P	
806422	CK-14	16	M14x2.0P	
806424	CK-16	18	M16x2.0P	
806426	CK-18	20	M18x2.5P	
806428	CK-20	22	M20x2.5P	

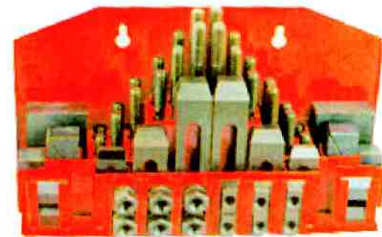

24PCS.Inch Stud each size X 4pcs:3",4",5",6"7"8"
6pcs table siot(t-slot)
6pcs fianged nuts
4pcs coupling nut
6pcs step clamps
6pcs stop blocks

A.T.C.Three point combination die

Applicable to all types of mechanical work table T groove, specifically for the mold, fixture plate fixed use

FIG.1

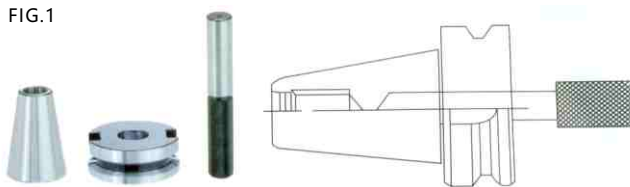
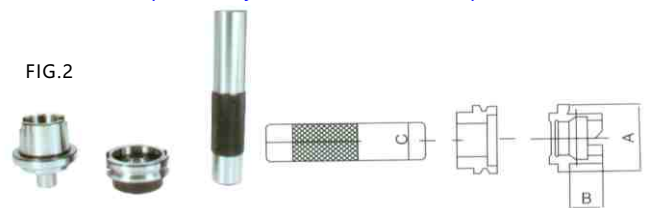

FIG.2



Taper Shank	Fig	Model No	A	B	C	Order Number	Price
MAS403-BT	1	BT30-ATC				806500	
		BT40-ATC				806502	
		BT50-ATC				806504	
SK-DIN69871A	1	SK30-ATC				806506	
		SK40-ATC				806508	
		SK50-ATC				806510	
CAT	1	CAT30-ATC				806512	
		CAT40-ATC				806514	
		CAT50-ATC				806516	
HSK	2	HSK50A-ATC	50	25	25	806518	
		HSK63A-ATC	63	32	30	806520	
		HSK100A-ATC	100	50	40	806522	